

Century Place

ST PAULS

APPROXIMATE FLOOR AREA
32 SQM / 344 SQFT



LOWER GROUND FLOOR

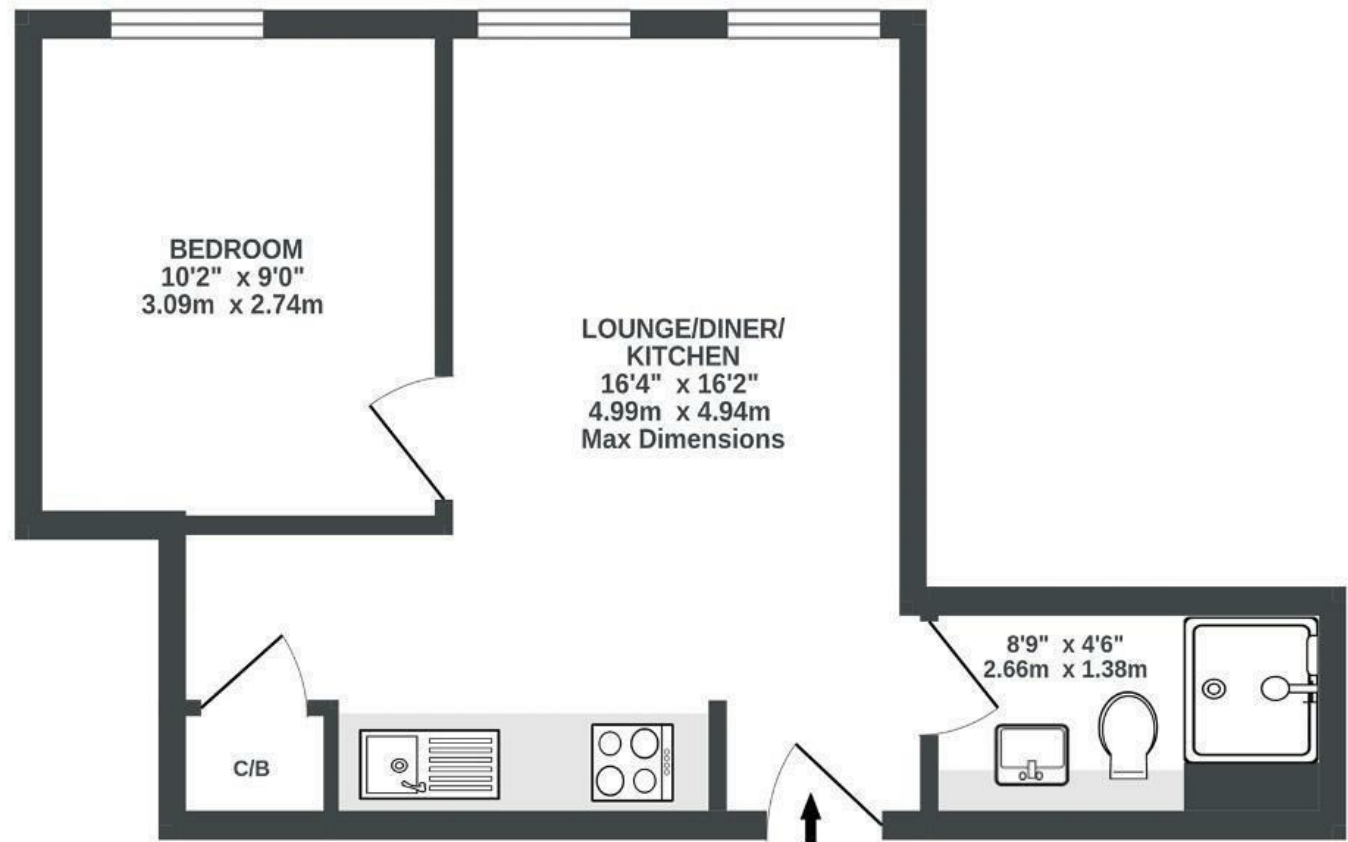

Illustrations are for reference purposes only, measurements are approximate, not to scale.

Boardwalk

St. Paul Street , BRISTOL



£195,000



1 Bedrooms



BS2 8AN



1 Bathrooms

"The property feels safe, cosy and secure as it is a basement - but you still get lots of natural light. It has been a very easy property to maintain and loved owning it."

